

LOC J	DIST	REVISIONS 変更					
		P	LTR	DESCRIPTION	DATE	DWN	APVD
			○	作成 (RELEASED) FJ00-1013-02	20SEP00	N.Y	M.S
			A	変更 (REVISED) FJ00-0524-02	06MAR02	N.Y	M.S

トレードマーク
TRADE MARK

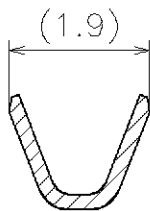

断面 A-A
SECT A-A

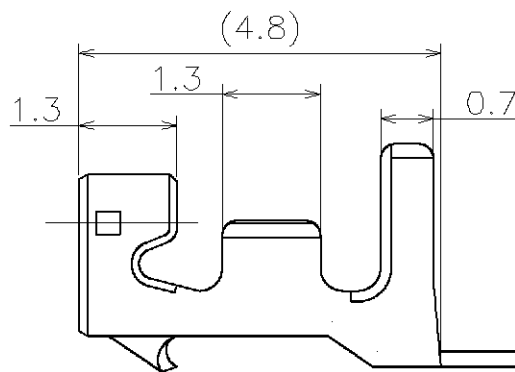
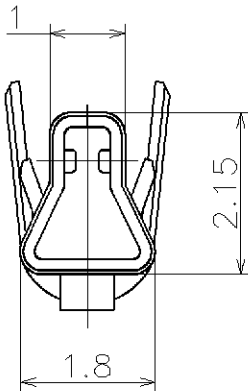
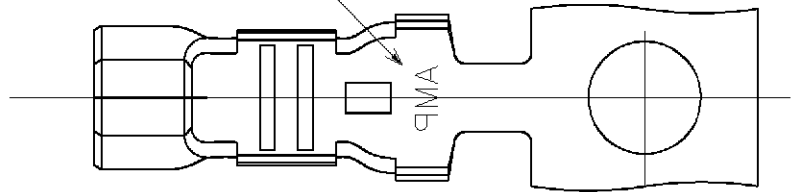
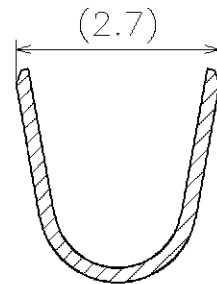

断面 B-B
SECT B-B

PRE TINNED PHOSPHOR BRONZE (0.2t) 錫めっき済み磷青銅 (板厚 0.2)	0-1376476-1
MATERIAL 材料	PART No 型番

WIRE RANGE 抱合電線断面積 AWG #26~#22(0.12~0.35mm ²)	INSULATION DIA 被覆外径 φ1.2 ~ 1.9
---	--------------------------------------

RELEASED FOR PUBLICATION

ALL RIGHTS RESERVED.

BY TYCO ELECTRONICS CORPORATION.

© COPYRIGHT

THIS DRAWING IS UNPUBLISHED.

DIMENSIONS: 単位: 耗 MM	DWN N.YAMASAKI	13MAR2002
	CHK M.SHINDO	20 SEP '02
TOLERANCES UNLESS OTHERWISE SPECIFIED: 一般公差 10> ; ±0.2 30> 10> ; ±0.25 100> 30> ; ±0.3 ANGLE ; ±3°	APVD Y.KASHIWA	20 SEP '02
	PRODUCT SPEC 製品規格 108-5703	
	APPLICATION SPEC 取付適用規格 114-5286	
WEIGHT	A4 00779 C-1376476	
CUSTOMER DRAWING		

MATERIAL 材料 表参照 (SEE TABLE)		FINISH 仕上 —
Tyco Electronics AMP K.K. Kawasaki, Japan		
NAME 名称 2.5mm SIGNAL MATE CONN REC CONT 2.5mmシグナルメイトコネクタリセコンタクト		
SIZE A4	CAGE CODE 00779	DRAWING NO 番号 C-1376476
RESTRICTED TO —		
SCALE 尺度		SHEET 1 OF 1 REV A